

Technical data:

Design and manufacture Standard : API 608

Flanged Size : ASME B 16.5

Face to Face : ASME B 16.10

Test and Inspection Standard : API598

The valve port sizes of serial valve connecting Flange and butt-welding terminal can be designed according to customer's

request

Forged steel floating ball valve RF flange design drawing

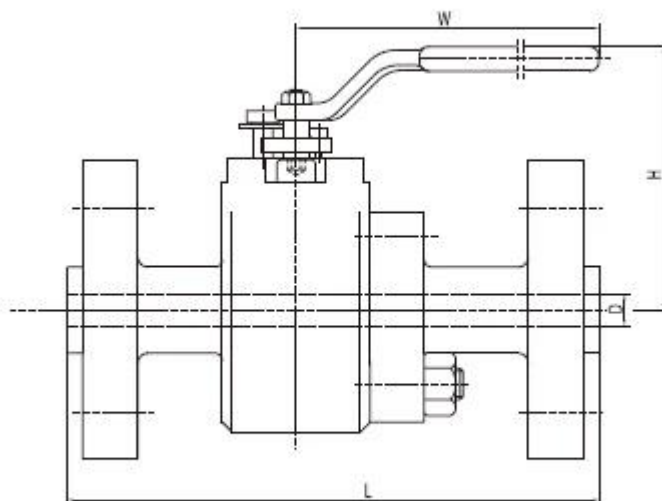

Full Port (1/2"~2")

Dimensions and Estimated table:

Class 1500 Dimension and Weight

Full Port											
Size		D		L		H		W		Weight	
in	mm	in	mm	in	mm	in	mm	in	mm	lb	Kg
1/2"	15	0,50	12,7	8,50	216	4,59	116,50	5,91	150	22,04	10
3/4"	20	0,75	19	9,02	229	5,35	136	7,09	180	28,66	13
1"	25	1,00	25,4	10,00	254	6,20	157,50	10,43	265	44,09	20
1-1/2"	40	1,50	38	12,01	305	6,99	177,50	11,81	300	90,39	41
2"	50	2,00	51	14,49	368	8,35	212	15,75	400	132,28	60